

SIGILVENTUS

EC MIXFLOW FAN

SAFETY & OPERATING INSTRUCTIONS

SIGILVENTUS

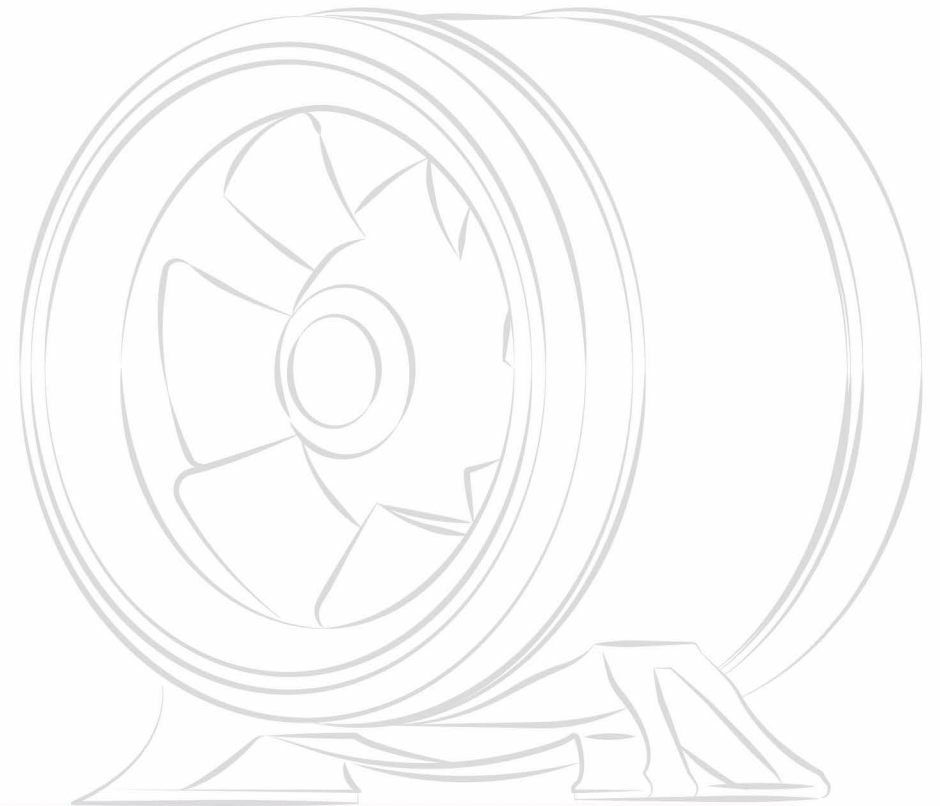

Please read the instruction manual carefully before use to avoid serious injury.

Thank you for purchasing this SigilVentus EC Mixflow Fan.

Please keep this instruction manual safe for future reference, along with the box for storage when the fan is not in use.

	<p>⚠ WARNING:</p> <p>Electrical Shock Hazard Do Not Open.No user serviceable parts inside. Refer servicing to qualified service personnel.</p>
--	---

- ⚠** 1.To avoid the risk of electrical shock, fire or injury to persons, always make sure the product is unplugged from the electrical outlet before relocating, servicing or cleaning it.
- 2.When using the SigilVentus ec mixflow fan, basic electrical safety precautions should always be followed.

CONTENTS

1 Safety Instructions

1.1 Warnings	1
1.2 Safety Instructions	1
1.3 Maintenance	2

2 Product Overview

2.1 Features	3
2.2 Product Content	3
2.3 Specifications	4
2.4 PQ Curve	6

3 Fan Controls

3.1 Standard Control	7
3.2 DIY 4 Pins Speed Control	7

4 Optional Controls & Accessory

4.1 Smart Controller With Probe	8
4.2 Wall Mounted Controller	8
4.3 Wireless Remote With Receiver	8
4.4 Adaptor To Other 3 Pins Controllers	8
4.5 Adaptor To Other RJ45 Controllers	9
4.6 3.5mm Trrs Jack Extension Control Cable	9

5 Installation

5.1 Warning	9
5.2 Wall Mounted Installation	10
5.3 Hang Installation	11
5.4 Intake And Exhaust	12

1 Safety Instructions

1.1 WARNINGS

This appliance is not intended for use by persons (including children) with reduced physical, sensory or mental capabilities, or lack of experience and knowledge, unless they have been given supervision or instruction concerning use of the appliance by a person responsible for their safety. Children should be supervised to ensure that they do not play with the appliance.

To ensure safety, please read and read the following instructions before using this fan

USE this fan only as intended. Use other than as described may result in electric shock or injury to persons.

WARNING: ALL SIGILVENTUS EC FANS DO NOT FUNCTION WITHOUT SPEED CONTROL CONNECTION. SPEED CONTROL MUST BE CONNECTED BEFORE POWER UP.

1.2 SAFETY INSTRUCTIONS

- This product is intended for indoor use only.
- Install with duct on inlet and duct and/or fan attenuator/silencer on exhaust of fan.
- Install guard screens if personnel have access to inlet or exhaust of fan.
- For general ventilation use only.
- **Warning:** Do not use to exhaust hazardous explosive materials and vapors.
- Ensure that the fan is switched off from the supply mains before removing the guard.
- Precautions must be taken to avoid the back-flow of gases, in this case, a check valve is necessary.
- **DO NOT** pull the cord too hard as it could damage and fray. If the supply cord is damaged, it must be replaced by the manufacturer, its service agent or similarly qualified persons in order to avoid an electrical hazard.
- **DO NOT** allow the power cord or any other parts of the fan to touch hot surfaces, open flames, cooking or other heating appliances and **DO NOT** place near hot gas or electric burners
- Ensure all the packaging has been removed and that the voltage used corresponds to the voltage indicated on the rating plate

- **DO NOT** cover any openings on the fan or insert objects or parts of the body into any of its openings when fan is on or off
- To protect against electric shock, do not immerse unit, plug or cord in water or other liquids
- Keep the cord away from areas where it could be walked on or tripped over
- To disconnect, first turn the unit off, grip the plug and pull from the wall outlet. **NEVER** pull the plug by the cord

- Turn the unit off when moving to another location and before cleaning

- **DO NOT** operate if the housing is damaged

DO NOT use this fan in the following circumstances.

- Flammable or hazardous atmosphere, near explosive gases, or chemical dust.
- Environmental humidity is above 90%.
- Operating Temperature is less than 15°F / -10°C, or above 140°F / 60°C.
- Environment with significant dust.
- Places where children or pets have easy access to the fan blades.

1.3 MAINTENANCE

- Clean the unit regularly to ensure the blades can move freely
- **DO NOT** clean whilst the unit is switch on. Turn off and unplug the unit
- **DO NOT** use cleaning detergent or chemicals to clean the fan
- Wipe the unit and blades with a damp cloth
- **DO NOT** spray water or liquid on or into the fan
- Never immerse in water or let water enter the fan controller outlet
- **DO NOT** clean the unit with cloths that have metal parts

2 Product Overview

2.1 FEATURES

SigilVentus MixFlow inline fan are powered by cutting-edge EC motor with multiple speed control (Potentiometer; PWM; 0-10V) and tachometer output. These fans feature high static air pressure, aerodynamically-optimized airflow, quiet operation, and extremely high efficiency. They are ideal for residential, commercial and industrial ventilation, and even hydroponic ventilation (exhaust and intake)

2.2 PRODUCT CONTENT

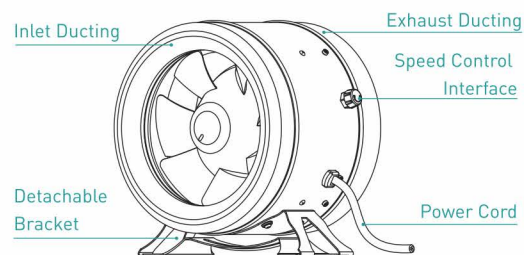

EC MixFlow Fan



8 Speeds Digital Controller*



Full Speed Plug

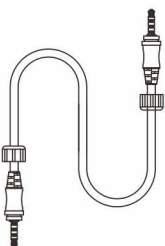

5 Meters Control Cable*

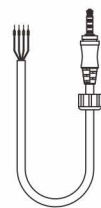

DIY Speed Control Cable

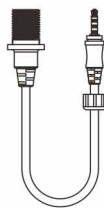

3 Pins Controller Adaptor

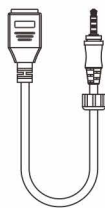

RJ45 Controller Adaptor

* may be replaced with wall-mounted variable speed controller and related control cable depending on actual package

2.3 SPECIFICATIONS

Model N°	Series Code	Dimensions		
SE-A100	T01			
SE-A125	T01			
SE-A150				
SE-A200				
SE-A250				
SE-A315	T01			

Model N°	Series Code	L1	L2	H1	H2	D1	D2	W1	W2	W3	Φ
SE-A100	T01	162	145	148	23	Φ125	Φ98	159	60	20	10
SE-A125	T01	162	145	151	23	Φ127	Φ124	110	60	12	10
SE-A150	T01	180	164	176	23	Φ154	Φ150	125	70	15	10
SE-A200	T01	230	214	225	23	Φ204	Φ200	160	80	30	10
SE-A250	T01	290	270	277	23	Φ254	Φ250	200	100	30	10
SE-A315	T01	360	336	256	40	Φ317	Φ313	290	164	38	9

Note: Dimension unit is mm, tolerance ± 1mm

Fan Specifications

Model N°	Series Code	Rated Voltage	Max. Power Consumption	Frequency	Max. Speed	Max. Airflow	Max. Static Pressure	Max. Noise Level
SE-A100	T01	110-120VAC	18W	50/60Hz	5000RPM	160CFM/275M ³ H	34mmH ₂ O/334Pa	56.8dBA
		220-240VAC	18W	50/60Hz	5000RPM	160CFM/275M ³ H	34mmH ₂ O/334Pa	56.8dBA
SE-A125	T01	110-120VAC	20W	50/60Hz	5000RPM	166CFM/280M ³ H	37mmH ₂ O/363Pa	54.4dBA
		220-240VAC	20W	50/60Hz	5000RPM	166CFM/280M ³ H	37mmH ₂ O/363Pa	54.4dBA
SE-A150	T01	110-120VAC	40W	50/60Hz	5000RPM	350CFM/594M ³ H	51mmH ₂ O/500Pa	60dBA
		220-240VAC	40W	50/60Hz	5000RPM	350CFM/594M ³ H	51mmH ₂ O/500Pa	60dBA
SE-A200	T01	110-120VAC	75W	50/60Hz	3800RPM	710CFM/1205M ³ H	53mmH ₂ O/520Pa	61.6dBA
		220-240VAC	75W	50/60Hz	3800RPM	710CFM/1205M ³ H	53mmH ₂ O/520Pa	61.6dBA
SE-A250	T01	110-120VAC	150W	50/60Hz	3200RPM	1065CFM/1808M ³ H	52mmH ₂ O/510Pa	65dBA
		220-240VAC	150W	50/60Hz	3200RPM	1065CFM/1808M ³ H	52mmH ₂ O/510Pa	65dBA
SE-A315	T01	110-120VAC	260W	50/60Hz	2800RPM	1639CFM/2787M ³ H	61mmH ₂ O/598Pa	76dBA
		220-240VAC	320W	50/60Hz	3000RPM	1757CFM/2987M ³ H	69mmH ₂ O/677Pa	78dBA

Note: The noise value is the measured value at the distance of 1 meter from the fan inlet

Dimensions

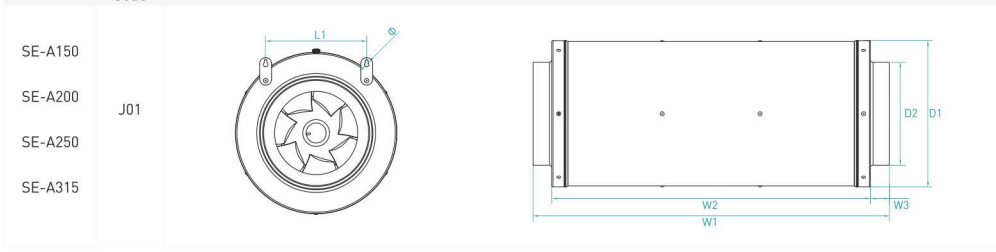

Model N°	Series Code	L1	D1	D2	W1	W2	W3	Φ
SE-A150	J01	123	Φ 243	Φ 148	547	469	39	10
SE-A200	J01	174	Φ 304	Φ 198	699	619	40	10
SE-A250	J01	221	Φ 353	Φ 248	859	769	45	10
SE-A315	J01	268	Φ 415	Φ 313	940	847	46	10

Note: Dimension unit is mm, tolerance \pm 1mm

Fan Specifications

Model N°	Series Code	Rated Voltage	Max. Power Consumption	Frequency	Max. Speed	Max. Airflow	Max. Static Pressure	Max. Noise Level
SE-A150	J01	110-120VAC	40W	50/60Hz	5000RPM	350CFM/594M ³ H	51mmH ₂ O/500Pa	50dBA
		220-240VAC	40W	50/60Hz	5000RPM	350CFM/594M ³ H	51mmH ₂ O/500Pa	50dBA
SE-A200	J01	110-120VAC	75W	50/60Hz	3800RPM	710CFM/1205M ³ H	53mmH ₂ O/520Pa	51dBA
		220-240VAC	75W	50/60Hz	3800RPM	710CFM/1205M ³ H	53mmH ₂ O/520Pa	51dBA
SE-A250	J01	110-120VAC	150W	50/60Hz	3200RPM	1065CFM/1808M ³ H	52mmH ₂ O/510Pa	55dBA
		220-240VAC	150W	50/60Hz	3200RPM	1065CFM/1808M ³ H	52mmH ₂ O/510Pa	55dBA
SE-A315	J01	110-120VAC	260W	50/60Hz	2800RPM	1639CFM/2787M ³ H	61mmH ₂ O/598Pa	66dBA
		220-240VAC	320W	50/60Hz	3000RPM	1757CFM/2987M ³ H	69mmH ₂ O/677Pa	68dBA

Note: The noise value is the measured value at the distance of 1 meter from the fan inlet

2.4 FAN PERFORMANCE CURVES VS. STATIC PRESSURE

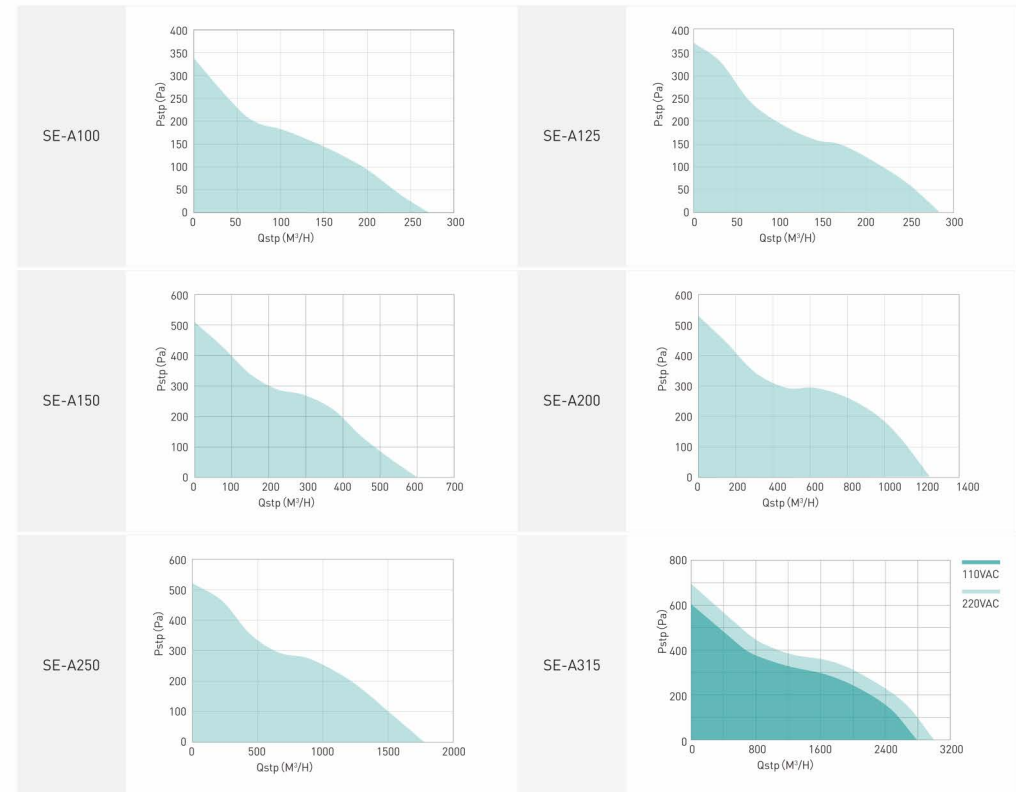

3 Fan Controls

SigilVentus EC MixFlow Fans offer multiple way to control the fan speed, supporting varies HVACR control system and compatible with other controllers by Potentiometer, PWM, 0-10V.

3.1 STANDARD CONTROL

All SigilVentus fans go with a standard digital speed controller with 8 speed levels or Other variable speed controller.

3.2 DIY 4-PINS CONTROL

All SigilVentus fans are packed with a DIY 4 pins connection cable, please refer to the diagram below.

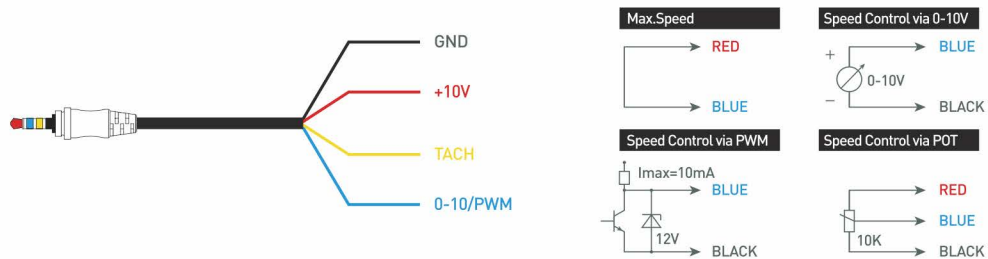

4 OPTIONAL CONTROLS & ACCESSORY

SigilVentus EC fan offers great flexibility and compatibility of speed control with various accessory: smart control, remote control, wall mounted variable control, controller adaptors and extension cable.



SMART CONTROLLER WITH PROBE (SOLD SEPARATELY)

6 speed controller with thermal probe for monitoring environmental temperature, accurate Ventilation and energy saving, supporting control of up to 4 EC fans simultaneously and mode selection of Manual, Auto and Alert.



WALL MOUNTED CONTROLLER (OPTIONAL)

This wall mounted controller gives 8 levels of fan speed with home switch panel fitting into in-wall installation of 86mmx86mm.



WIRELESS REMOTE WITH RECEIVER (SOLD SEPARATELY)

Allows you to control your EC fan wirelessly. 6 pre-set speed levels (15-100% output). 50ft / 15m signal range, which works through walls, floors and ceilings. Ideal for fans installed in hard to reach places.



ADAPTOR TO OTHER 3 PINS CONTROLLERS

This adaptor has a male 3.5MM TRRS Jack and female 3PINS connector It gives additional support for using SigilVentus EC fans with other EC fan controller in the market, e.g. GAS type No.150 Digital EC fan Controller, GAS type No.501 Digital EC 5 Controller



ADAPTOR TO OTHER RJ45 CONTROLLERS

This adaptor is with 3.5MM TRRS male jack and RJ45 female connector It gives additional support for using SigilVentus EC fans with other EC fan controller in the market, e.g. PRIMA KLIMA ECTC-1M display controller.



3.5MM TRRS JACK EXTENSION CONTROL CABLE

(SOLD SEPARATELY)

5 meters long extension cable for flexible controller installation in a long distance within 10 meters

5 Installation

5.1 WARNING: MUST CONNECT SECURELY TO SPEED CONTROL BEFORE POWER UP

- Unpack and check fan for damage; ensure that the fan impeller spins freely and not touching fan housing.
- Use a pre-filter on the absorption axis to prevent dust, oil and other foreign substances from building up on the impeller. Build up of dust and or foreign material can cause an out-of-balance impeller and excessive vibration. Excessive vibration will reduce fan life expectancy.
- Use the appropriate attachment screws for the surface material being selected to mount the fan. Use the supplied mounting bracket or hanger.
- Do not install fan on sheet rock or weak surface.
- Do not deform fan bracket or fan housing.
- After completing the installation, electrical work and duct work, Perform the test operation to confirm if the fan operates normally.
- After turning the power on the fan should rotate freely and build up speed normally.
- If there is abnormal noise or no rotation, check all connections and check power supply.
- Always install the fan at the height of 2.1m or above

5.2 WALL MOUNTED INSTALLATION

- 1 Mark the screw position on the wall

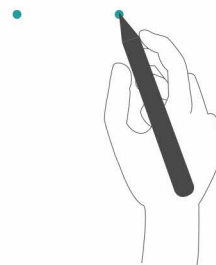

- 2 Punch holes in the wall



- 3 Screw the fan onto the wall

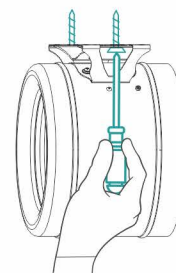

- 4 Connect the ducts on two sides with clamps

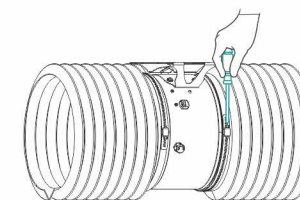

- 5 Connect the speed control to the fan and make sure the connection is in place and fastened

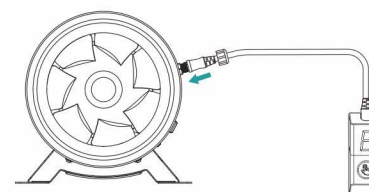

- 6 Power up the fan

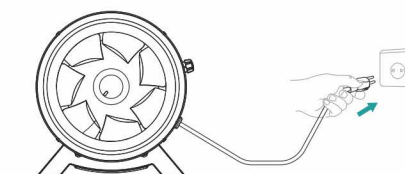

5.3 HANG INSTALLATION

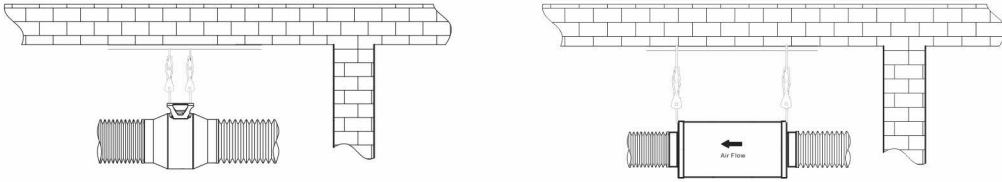

5.4 INTAKE AND EXHAUST

This fan can be used as either an intake fan or exhaust fan in grow rooms or tents to achieve optimal whole space ventilation.

- Used as the intake fan or opening: If it's not used as a fan, it must be situated at a bottom corner of your grow space.
- Used as the exhaust fan: It must be hung (shown above) or mounted at the highest opposite corner.

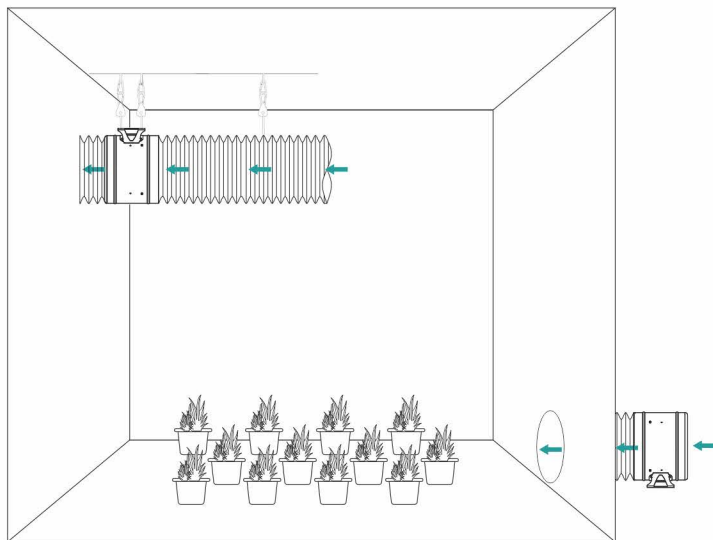

ENVIRONMENTAL PROTECTION



Disposal

This symbol indicates that this product must not be placed in general household waste. It should be sent to a separate recycling facility for recovery, check local authorities for details.

By responsible recycling and separating this product from other household waste it will help protect the environment and human health, as the volume of waste sent to incinerators or land-fills will be reduced and natural resources conserved.